

VERTICAL ARTICULATED ROBOT **RV20-1803**

HIGHLY DYNAMIC 6-AXIS ARTICULATED ARM ROBOT FOR PRECISE INDUSTRIAL APPLICATIONS

The REIS **RV20-1803** is a highly developed 6-axis articulated arm robot that offers exceptional precision and dynamics with a nominal payload of 20 kg. The **RV20** is ideally suited for testing & measuring tasks as well as handling and laser applications. With its minimal footprint, it is also ideally suited for installation in systems with very limited space.

Top class technology top class

Equipped with six rotary axes, the **RV20-1803** offers full freedom of movement (6DoF: three translational and three rotational degrees of freedom), making it a versatile solution for complex industrial applications.

Perfect coordination with the control system

In combination with the advanced REIS ROBOTstar VII robot controller, the **RV20-1803** unfolds its full potential. The precise path control technology of the REIS ROBOTstar VII, in combination with the SINAMICS hardware and control technology, ensures optimum management of the complete servo drive technology, including powerful servomotors.



Maximum performance thanks to high-quality materials

The REIS RV series sets new standards in its class through the use of precise high-performance gearboxes and mechanics designed for maximum rigidity, natural frequency

and damping. The construction includes innovative material combinations of steel, aluminum, magnesium and carbon fiber composites to ensure maximum stability with minimum weight.



VERTICAL ARTICULATED ROBOT RV20-1803

Technical data

Nominal load capacity	kg	20
Additional load on arm A3	kg	10
Number of axes		6
Protection class	IP	64
Weight of basic unit (without control unit)	kg	194

Speeds

A1	°/s	200
A2	°/s	180
A3	°/s	200
A4	°/s	500
A5	°/s	500
A6	°/s	500

Swivel range of traversing axis Axis 1 to 6

Swivel range A1	°	±185
Swivel range A2	°	-88 / +169
Swivel range A3	°	-142 / +78
Swivel range A4	°	±185
Swivel range A5	°	-115 / +125
Swivel range A6	°	±360

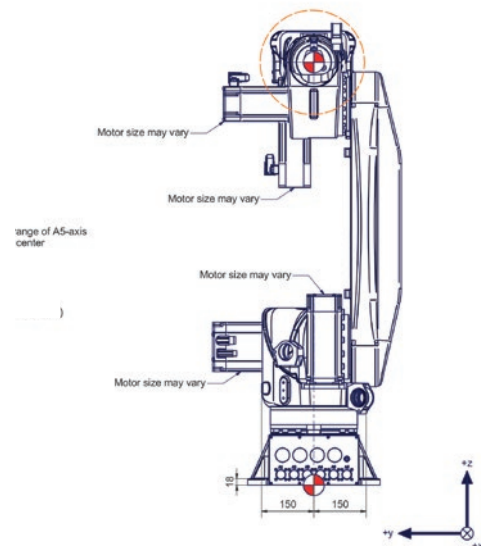

A (2 : 1)
Tool mounting flange

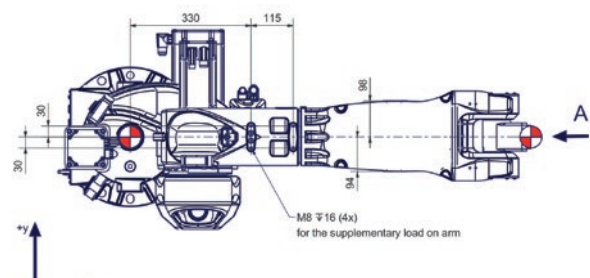
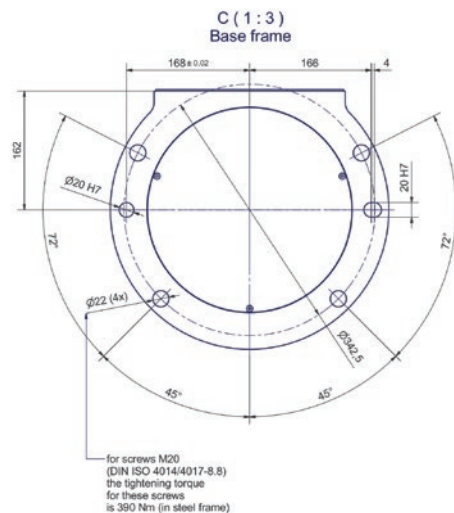

VERTICAL ARTICULATED ROBOT

RV20-1803

MECHANICAL INTERFACE

Type	d ₁	d ₂ h ₈	d ₃ H ⁷	d ₄	N	d ₅ H ⁷	x	y	t ₁	t ₂	t ₃	t ₄
	mm	mm	mm	mm		mm	°	°	mm	mm	mm	mm
RV20-1803	50	63	31.5	M6	4	6	45	90	10	7	6	10

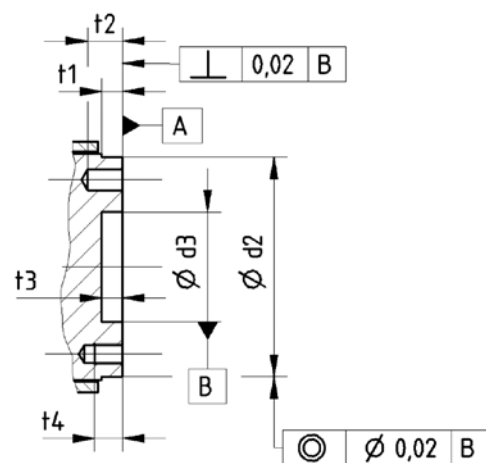
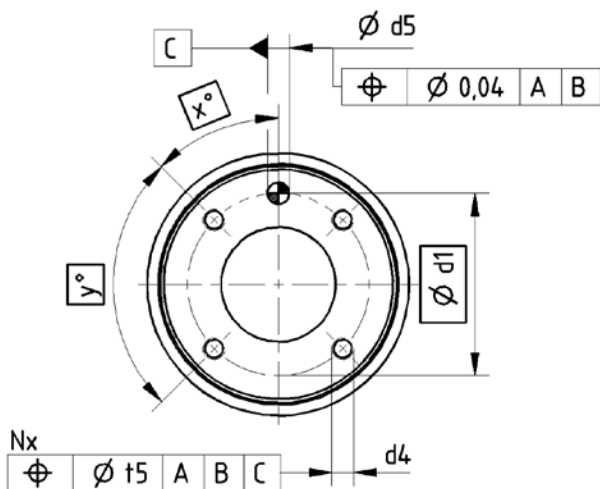
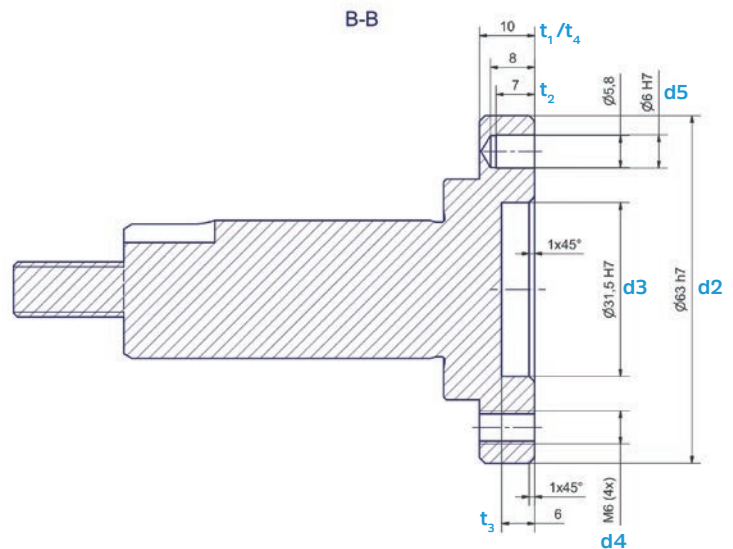
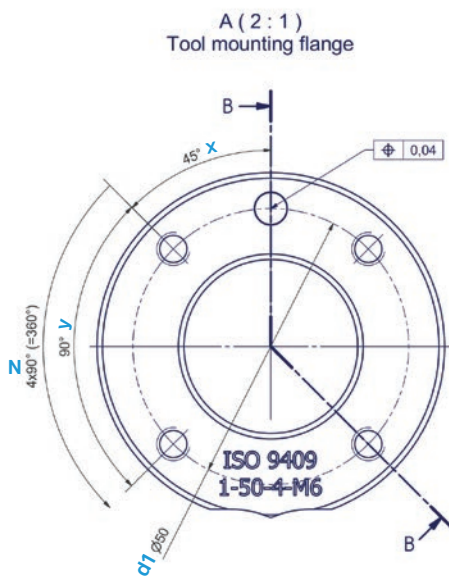

A dowel pin is required in addition to the internal or external centering to fix the position

From the position shown, a rotation range of $\pm 360^\circ$ is possible.

